

**FORM B: CAPITAL APPLICATION**

**PROJECT NAME:** Underground, U-Channel Steel Arched Roof Beam Support  
**PROJECT** NIVITGEKA JEAN PIERRE  
**DATE:** 22 January 2025  
**CA NO.:** \_\_\_\_\_  
**CONS. ASS. NO.:** \_\_\_\_\_

| A | PROJECT DESCRIPTION  |
|---|--|
|   | Underground, U-Channel Steel Arched Roof Beam Support; 3M*3M and 2.5M*2.5M (SHANDONG CHINA COAL) |

| B | MOTIVATION |
|---|------------|
|---|------------|

Underground support to be installed for tunnel support (Ground conditions) The steel support hold and support soft grounds. This will provide a safe working environment for underground workers. Introduction of Steel Support U Beam Arched Roof U29 Shape Steel Arches with Good Pressure for Tunnel Support and easy to install.

U-Channel Steel Support, also known as U-shaped steel channels or simply U channels, is a widely used structural component in the construction and manufacturing industries. It is characterized by its distinctive U-shaped cross-section, which provides excellent strength and rigidity while minimizing weight. U Channel Steel Support is primarily employed for structural support and reinforcement applications, offering stability and load bearing.

U-Channel Steel Support is manufactured from various materials, including carbon steel, stainless steel, and aluminium, to accommodate different project requirements. These materials offer varying

| Ref Number | Date of Implementation | Date of last revision | Version |
|------------|------------------------|-----------------------|---------|
|            |                        |                       |         |

versatility, and durability make it a popular choice for a wide range of applications, contributing to the strength and integrity of various structures and systems.

| C                          |          |      |            |             | SELECTED COSTING OPTION |  |
|----------------------------|----------|------|------------|-------------|-------------------------|--|
| EQUIPMENT LIST             | QUANTITY | UNIT | UNIT PRICE | PRICE (USD) |                         |  |
| Costing                    |          |      |            |             |                         |  |
| 29U Steel Arches 3M*3M     | 100      | SETS | 386        | 38,600      |                         |  |
| 29U Steel Arches 2.5M*2.5M | 110      | SETS | 210        | 23,100      |                         |  |
| Sub Total                  |          |      |            | 61,700      |                         |  |
| Taxes and Assessment       |          |      |            | 0           |                         |  |
| TOTAL                      |          |      |            | 61,700      |                         |  |

**D RISK ASSESSMENT**

Without Underground support equipment there will be a risk of fall of ground which could result in accidents. This will create a safe working environment for underground operations.

|  |  |
|--|--|
|  |  |
|--|--|

|            |                        |
|------------|------------------------|
| Ref Number | Date of Implementation |
| Version    | Date of last revision  |

2025 Budget : \$ 20,000,000

|  |                        |  |            |
|--|------------------------|--|------------|
|  | Date of last revision  |  | Version    |
|  | Date of Implementation |  | Ref Number |



TRINITY  
NYAKABINGO

架支脚型621

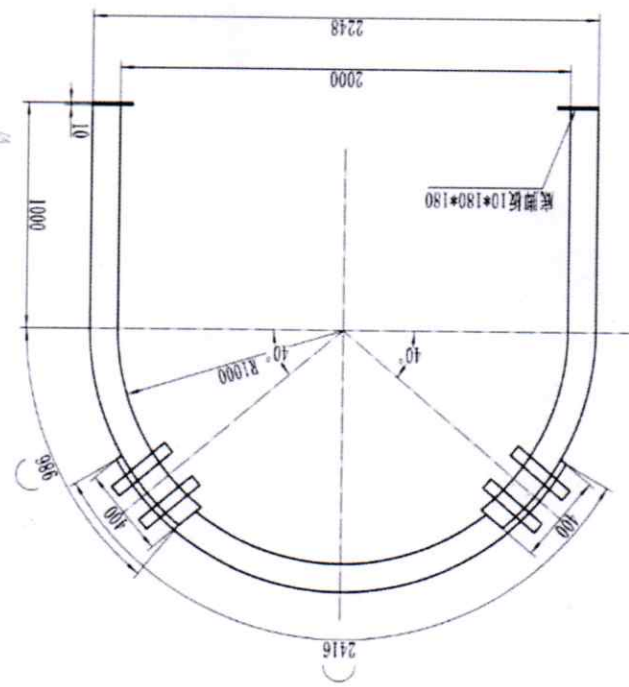

说明:

1. 本图采用U29型钢分三节制作。
2. 搭接处长度400mm, 用两副卡箍连接, 共四副卡箍。
3. 底脚板采用10\*180\*180钢板制作, 焊接方式如图所示。

|         |  |         |       |      |            |    |      |    |
|---------|--|---------|-------|------|------------|----|------|----|
| U29型钢支架 |  | U29型钢支架 |       | 材料   | 规格         | 数量 | 比例   | 备注 |
|         |  | U29型钢   | U29型钢 | Q235 | 100*100*10 | 1  | 1:14 |    |
| 中心架     |  | 中心架     |       | 材料   | 规格         | 数量 | 比例   | 备注 |
|         |  |         |       | Q235 | 100*100*10 | 1  | 1:14 |    |

|            |                        |         |                       |
|------------|------------------------|---------|-----------------------|
| Ref Number | Date of Implementation | Version | Date of last revision |
|            |                        |         |                       |



Introduction of Mining Support U Beam Steel Arch Supports

Mining Support U Beam Steel Arch Support is mainly used for mining tunnel support, with the features of high pressure steel structure.

Main purposes: mainly used in mine tunnel, mine tunnel secondary purpose of support, as well as the support of the mountain tunnel support.

Main features: pressure, supporting a long time, easy to install is not easy deformation

characteristics:

1) Specification: U25, U29, U36;

2) Assembly: top beam, two landing legs, four clamps, two baseplates

3) Material: 20MnK Q275

4) Grade: SS400 Q235 A36

5) Size: 50mm\*37mm\*4.5mm-320mm\*88mm\*8mm

**Parameter of Mining Support U Beam Steel Arch Supports**

| Size | Material     | Theoretical weight (kg/m) | cross-sectional area (cm <sup>2</sup> ) | Height              | Thickness            | Width                 | Leg thickness       |
|------|--------------|---------------------------|---|---------------------|----------------------|-----------------------|---------------------|
| 25U  | Q275B/ 20MnK | 24.95                     | 31.79                                   | +1.0<br>120<br>-1.5 | +0.5<br>15<br>-1.2   | +1.0<br>130<br>-3.0   | +0.8<br>6.3<br>-0.5 |
| 29U  | Q275B/ 20MnK | 29.00                     | 37.00                                   | +1.0<br>124<br>-1.5 | +0.5<br>16<br>-1.2   | +1.0<br>150.5<br>-3.0 | +0.8<br>7.2<br>-0.5 |
| 36U  | 20MnK        | 35.87                     | 45.70                                   | +1.0<br>138<br>-1.5 | +0.5<br>17<br>-1.2   | +1.0<br>171<br>-3.0   | +0.8<br>7.8<br>-0.5 |
| 40U  | 20MnK        | 40.05                     | 51.02                                   | +1.0<br>149<br>-1.5 | +0.5<br>20.2<br>-1.2 | +1.0<br>171<br>-3.0   | +0.8<br>8.5<br>-0.5 |

| Ref Number | Date of Implementation | Version | Date of last revision |
|------------|------------------------|---------|-----------------------|
|            |                        |         |                       |

**Basic Info.**

|                         |                         |                                      |                                       |
|-------------------------|-------------------------|--------------------------------------|---------------------------------------|
| Model NO                | U series                | Type                                 | Channel Steel                         |
| Standard                | GB                      | Trademark                            | Special Purpose Steel, China Coal     |
| Forming                 | Cold Drawn Steel        | Connection Form                      | Bolt Connection                       |
| Member                  | Steel Beam              | Type of Steel for Building Structure | High-Strength Steel                   |
| Carbon Structural Steel | Q195                    | Residential Wall Structure           | Wall Stud                             |
| Application             | Steel Workshop          | After-Sales Service                  | Video or Technical Support            |
| Transport Package       | Export Standard Package | Origin                               | Jining City, Shandong Province, China |

|            |  |                        |  |
|------------|--|------------------------|--|
| Ref Number |  | Date of Implementation |  |
| Version    |  | Date of last revision  |  |

ASAP (As soon as possible)

**E PROJECT SCHEDULE**

|  |
|--|
|  |
|--|

**F COMMENTS**

|  |
|--|
| <p>We need the Underground support equipment to hold and support soft grounds. This will provide a safe working environment for underground workers.</p> |
|--|

GENERAL

MANAGER/GM



GROUP FINANCE

CONTROLLER

*This is under budget*

GROUP LEGAL

COUNSEL &

COMPLIANCE

OFFICER

*26/02/2025*

GROUP SUPPLY

CHAIN

MANAGER

*George Sando*

*10/04/2025*

COO

*OT. — 27/02/25*

CFO

*1/5/2025*

**G APPROVAL**

|  |
|--|
|  |
|--|

Ref Number

Date of Implementation

Version

Date of last revision

|  |
|--|
|  |
|--|

CEO

BOARD

NOTE: attach additional quotes or supporting documents if necessary

|            |  |                        |  |
|------------|--|------------------------|--|
| Ref Number |  | Date of Implementation |  |
| Version    |  | Date of last revision  |  |

**SUPPLY CHAIN  
SOLE SUPPLIER MOTIVATION / BID WAIVER FORM**

**In compliance to FIN 01: DELEGATION OF AUTHORITIES POLICY**

- All Purchase Orders > \$ 500 must be supported by 3 quotes obtained through the tender process by the Supply Chain Department.
- All exceptions to the tender 3 quote Procurement process will be subject to a written Deviation Request, being in the form of a Bid Waiver Motivation/Sole Supplier Motivation.
- A Bid Waiver Motivation should be completed in instances where there are other potential suppliers, but sound reasons exist not to go out on tender to multiple potential bidders, before selecting the final supplier.
- A Sole Supplier Motivation shall be used only in instances where there is no other supplier providing the required product(s) and/or service(s).

**SOLE SUPPLIER MOTIVATION**

**BID WAIVER MOTIVATION**

(Tick the appropriate box)

Discipline/Department:

MINING DEPARTMENT

Contact person:

Jean Pierre NITTEGEKA

Tel. no.:

+250788601775

(Approved document to be attached to the Purchase Requisition)

|  |   |
|--|---|
| Product(s) or service(s) required                            | UNDERGROUND STEEL ARCHES  |
| Background information                                       | We need the Underground support equipment to hold and support soft grounds. This will provide a safe working environment for underground workers. |
| Scope of service(s) or product(s) required                   | 3M*3M<br>2.5M*2.5M (STEEL ARCHES)   |
| Details of recommended supplier                              | SHANDONG CHINA COAL INDUSTRY & MINING SUPPLIERS GROUP CO.,LTD   |
| Motivation for recommending this supplier                    | We recommend this supplier because they meet with our requirements.   |
| Estimated Value/Budget and Cost                              | \$61,700  |
| What other Mine/Mines are using this service(s)/ product(s)? | -   |



Date

10/04/2025

Group Procurement Superintendent

Date

10/04/2025

> \$ 5 000 Group Supply Chain Manager