

FORM B: CAPITAL APPLICATION

PROJECT NAME: Underground, U-Channel Steel Arched Roof Beam Support
PROJECT NIVITGEKA JEAN PIERRE
DATE: 22 January 2025
CONS. ASS. NO.: _____
CA NO.: _____

A	PROJECT DESCRIPTION
	Underground, U-Channel Steel Arched Roof Beam Support; 3M*3M and 2.5M*2.5M (SHANDONG CHINA COAL)

B	MOTIVATION
---	------------

Underground support to be installed for tunnel support (Ground conditions) The steel support hold and support soft grounds. This will provide a safe working environment for underground workers. Introduction of Steel Support U Beam Arched Roof U29 Shape Steel Arches with Good Pressure for Tunnel Support and easy to install.

U-Channel Steel Support, also known as U-shaped steel channels or simply U channels, is a widely used structural component in the construction and manufacturing industries. It is characterized by its distinctive U-shaped cross-section, which provides excellent strength and rigidity while minimizing weight. U Channel Steel Support is primarily employed for structural support and reinforcement applications, offering stability and load bearing.

U-Channel Steel Support is manufactured from various materials, including carbon steel, stainless steel, and aluminium, to accommodate different project requirements. These materials offer varying

Ref Number	Date of Implementation	Version

versatility, and durability make it a popular choice for a wide range of applications, contributing to the strength and integrity of various structures and systems.

C					SELECTED COSTING OPTION	
EQUIPMENT LIST	QUANTITY	UNIT	UNIT PRICE	PRICE (USD)		
Costing						
29U Steel Arches 3M*3M	100	SETS	386	38,600		
29U Steel Arches 2.5M*2.5M	110	SETS	210	23,100		
Sub Total				61,700		
Taxes and Assessment				0		
TOTAL				61,700		

D RISK ASSESSMENT

Without Underground support equipment there will be a risk of fall of ground which could result in accidents. This will create a safe working environment for underground operations.

--	--

Ref Number	Date of Implementation
Version	Date of last revision

2025 Budget : \$ 20,000,000

	Date of last revision		Version
	Date of Implementation		Ref Number



TRINITY
NYAKABINGO

架支脚型621

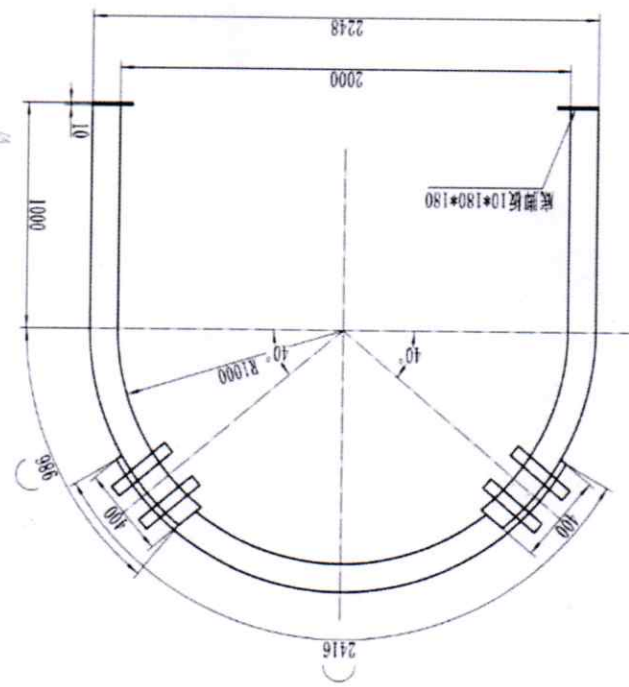

说明:

1. 本图采用U29型钢分三节制作。
2. 搭接处长度400mm, 用两副卡箍连接, 共四副卡箍。
3. 底脚板采用10*180*180钢板制作, 焊接方式如图所示。

U29型钢支架	U29型钢支架	材料	规格	数量	重量
		U29型钢	U29	1	1.14
中心架		材料	规格	数量	重量
		U29型钢	U29	1	1.14

Ref Number	Date of Implementation	Version	Date of last revision

Introduction of Mining Support U Beam Steel Arch Supports

Mining Support U Beam Steel Arch Support is mainly used for mining tunnel support, with the features of high pressure steel structure.

Main purposes: mainly used in mine tunnel, mine tunnel secondary purpose of support, as well as the support of the mountain tunnel support.

Main features: pressure, supporting a long time, easy to install is not easy deformation

characteristics:

1) Specification: U25, U29, U36;

2) Assembly: top beam, two landing legs, four clamps, two baseplates

3) Material: 20MnK Q275

4) Grade: SS400 Q235 A36

5) Size: 50mm*37mm*4.5mm-320mm*88mm*8mm

Parameter of Mining Support U Beam Steel Arch Supports

Size	Material	Theoretical weight (kg/m)	cross-sectional area (cm ²)	Height	Thickness	Width	Leg thickness
25U	Q275B/ 20MnK	24.95	31.79	+1.0 120 -1.5	+0.5 15 -1.2	+1.0 130 -3.0	+0.8 6.3 -0.5
29U	Q275B/ 20MnK	29.00	37.00	+1.0 124 -1.5	+0.5 16 -1.2	+1.0 150.5 -3.0	+0.8 7.2 -0.5
36U	20MnK	35.87	45.70	+1.0 138 -1.5	+0.5 17 -1.2	+1.0 171 -3.0	+0.8 7.8 -0.5
40U	20MnK	40.05	51.02	+1.0 149 -1.5	+0.5 20.2 -1.2	+1.0 171 -3.0	+0.8 8.5 -0.5

Ref Number	Date of Implementation	Version	Date of last revision

Basic Info.

Model NO	U series	Type	Channel Steel
Standard	GB	Trademark	Special Purpose Steel, China Coal
Forming	Cold Drawn Steel	Connection Form	Bolt Connection
Member	Steel Beam	Type of Steel for Building Structure	High-Strength Steel
Carbon Structural Steel	Q195	Residential Wall Structure	Wall Stud
Application	Steel Workshop	After-Sales Service	Video or Technical Support
Transport Package	Export Standard Package	Origin	Jining City, Shandong Province, China

Ref Number		Date of Implementation	
Version		Date of last revision	

CEO

BOARD

NOTE: attach additional quotes or supporting documents if necessary

Ref Number		Date of Implementation	
Version		Date of last revision	

**SUPPLY CHAIN
SOLE SUPPLIER MOTIVATION / BID WAIVER FORM**

In compliance to FIN 01: DELEGATION OF AUTHORITIES POLICY

- All Purchase Orders > \$ 500 must be supported by 3 quotes obtained through the tender process by the Supply Chain Department.
- All exceptions to the tender 3 quote Procurement process will be subject to a written Deviation Request, being in the form of a Bid Waiver Motivation/Sole Supplier Motivation.
- A Bid Waiver Motivation should be completed in instances where there are other potential suppliers, but sound reasons exist not to go out on tender to multiple potential bidders, before selecting the final supplier.
- A Sole Supplier Motivation shall be used only in instances where there is no other supplier providing the required product(s) and/or service(s).

SOLE SUPPLIER MOTIVATION

BID WAIVER MOTIVATION

(Tick the appropriate box)

Discipline/Department:

MINING DEPARTMENT

Contact person:

Jean Pierre NITTEGEKA

Tel. no.:

+250788601775

(Approved document to be attached to the Purchase Requisition)

Products) or service(s) required	UNDERGROUND STEEL ARCHES
Background information	We need the Underground support equipment to hold and support soft grounds. This will provide a safe working environment for underground workers.
Scope of service(s) or product(s) required	3M*3M 2.5M*2.5M (STEEL ARCHES)
Details of recommended supplier	SHANDONG CHINA COAL INDUSTRY & MINING SUPPLIERS GROUP CO.,LTD
Motivation for recommending this supplier	We recommend this supplier because they meet with our requirements.
Estimated Value/Budget and Cost	\$61,700
What other Mine/Mines are using this service(s)/ product(s)?	-

> \$ 5 000 Group Supply Chain Manager
Date

Group Procurement Superintendent
Date